

King's Cross floor plan

Finding your way around King's Cross

From 19 March, you'll notice some big changes to how you get around King's Cross. This has been designed to ensure your journey experience is as smooth as possible.

When catching a train from King's Cross, you'll need to enter the station into the new Western concourse and make your way to the platform from here.

A new entrance from King's Cross / St. Pancras underground station will bring you directly into the Western concourse. This will be clearly signposted as you exit the underground ticket gates.

When arriving into King's Cross by train, you'll exit the station in the same way you do now – either onto the street or down to the underground. As this area will be for arrivals only, you'll find it much easier to get where you're heading to.

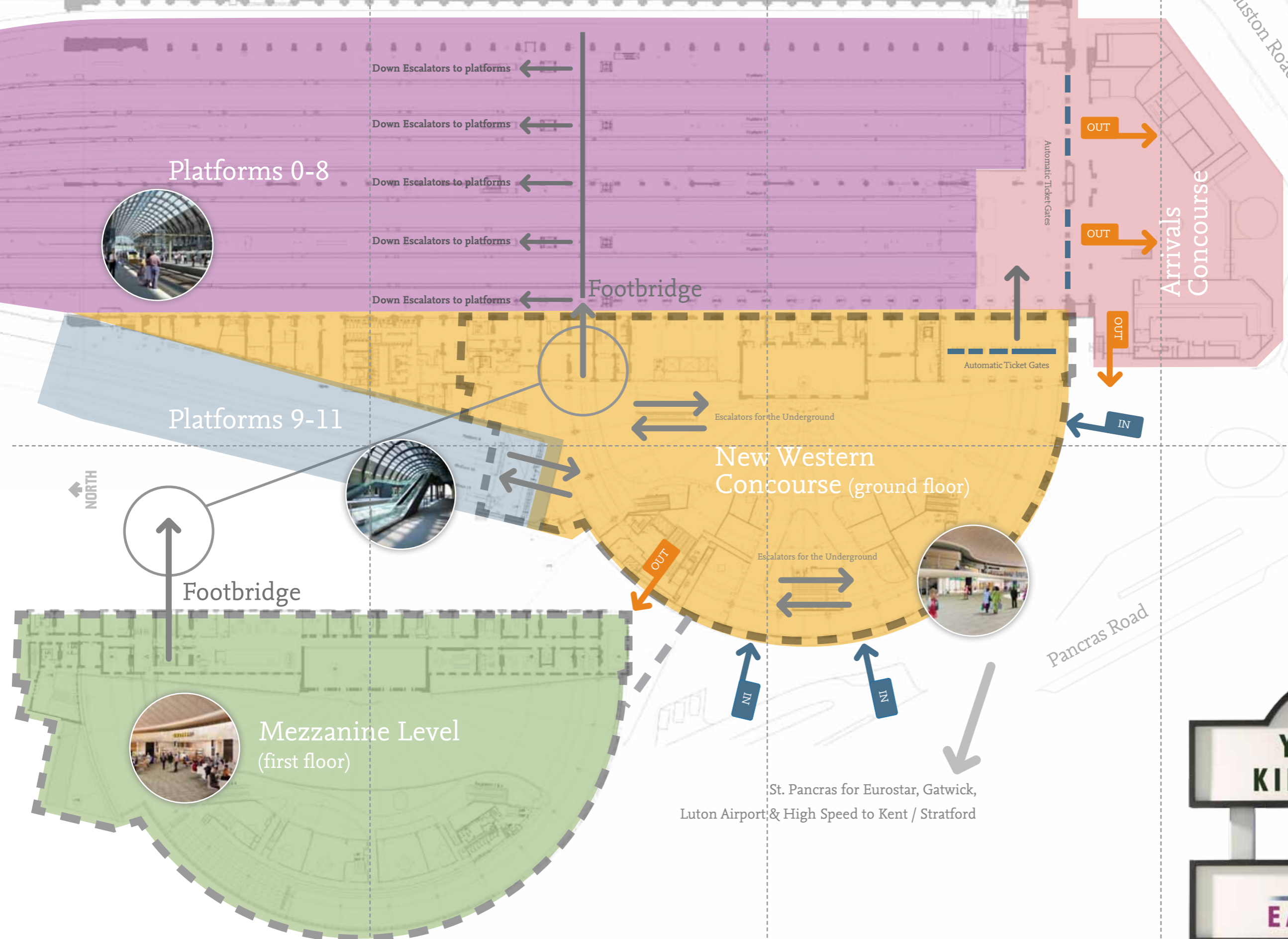

eastcoast.co.uk/kingscross



St. Pancras for Eurostar, Gatwick, Luton Airport & High Speed to Kent / Stratford

King's Cross facilities

Key

Ticket Machines	Passenger Seating & Restaurants	Meeting Point	Customer Information Screens
Customer Information Point	Left Luggage	ATM Machines	First Class Lounge Entrance
Toilets	First Class Lounge	Escalator	Taxi
Platform 9 3/4 Sign Post	British Transport Police	Ladies Toilets	

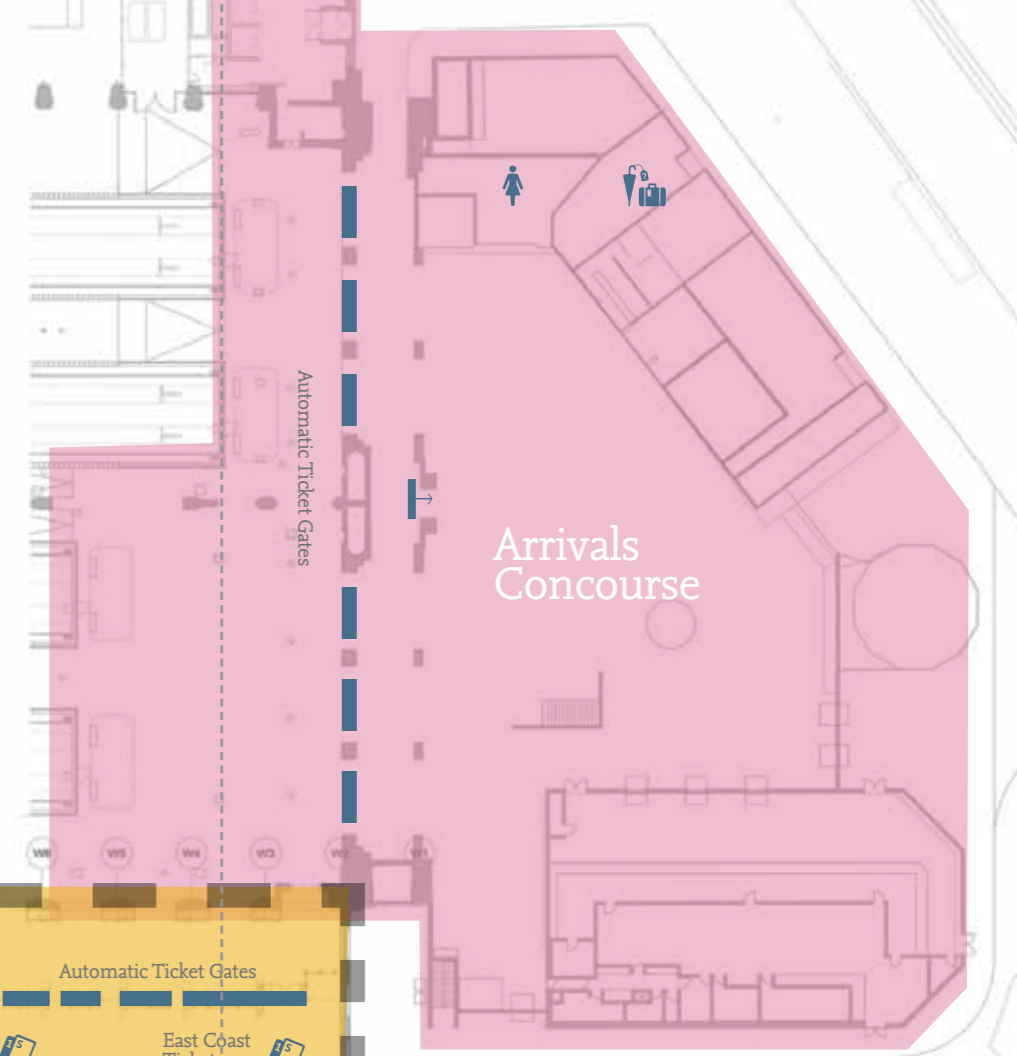

NORTH

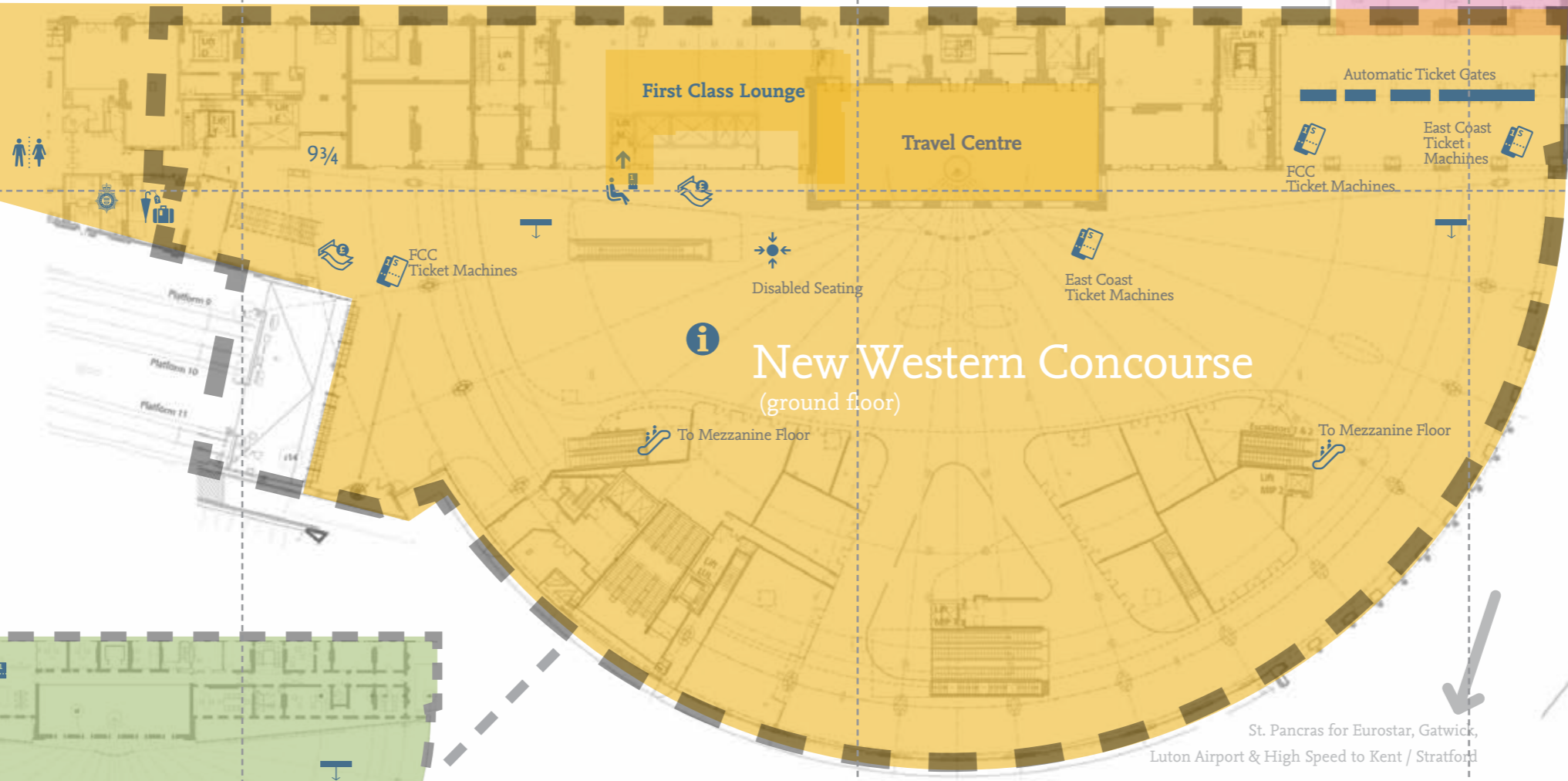

Taxi Pick Up

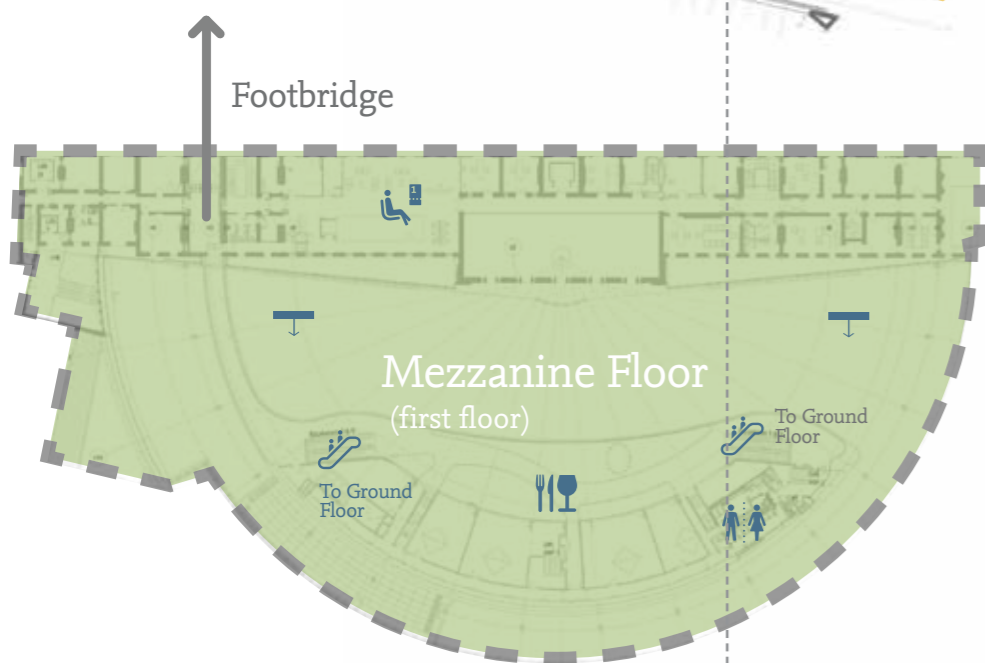

Disabled Parking

Taxi Set Down

St. Pancras for Eurostar, Gatwick, Luton Airport & High Speed to Kent / Stratford

